



The breathtaking views are just the beginning for flawless meetings and ultimate events.



Offering 9 unique venues totalling 1,900 square metres of meeting/event space perfect for any occasion.

Venue and Meeting Inclusions

- Introducing the new Similan Ballroom, a 6-metre high pillarless ballroom with multiple breakout rooms.
- Expansive pre-function areas and poolside lawn.
- Beachfront location ideal for team building.
- Event and catering team look after every detail.
- Single-use plastic free resort initiatives.



Our event and banquet team will help you every step of the way.

Meeting Venues at the New Meetings and Events Centre

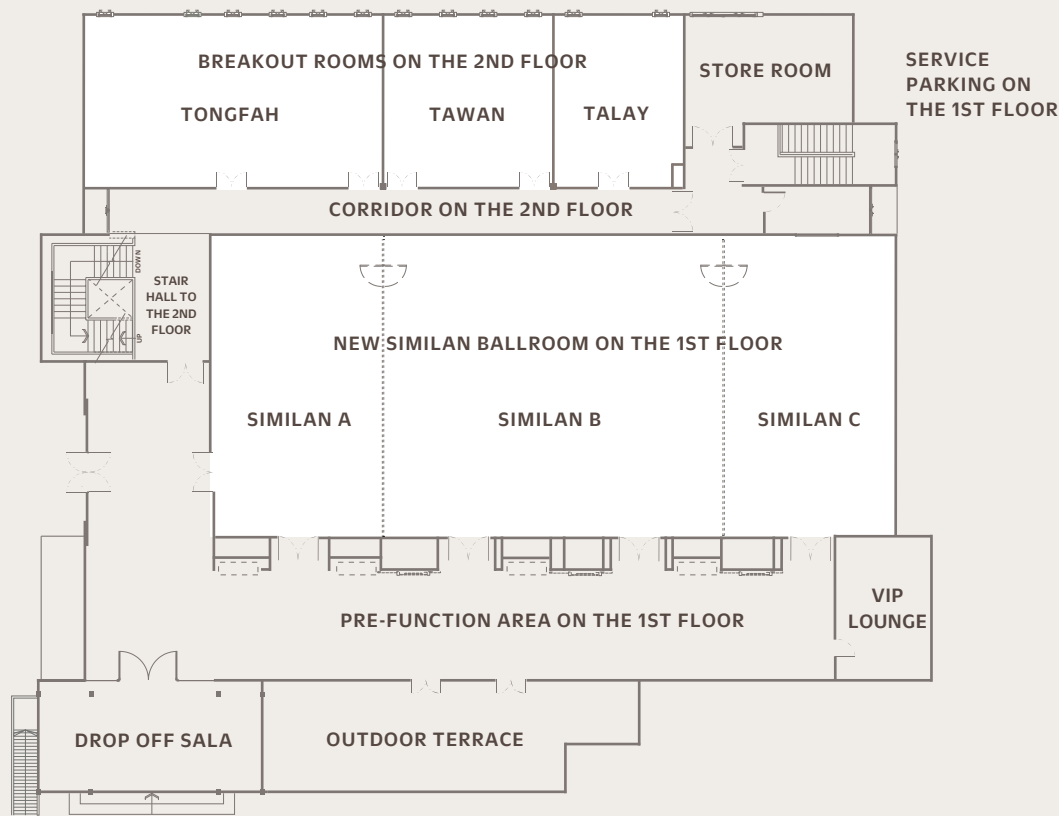

Meeting Venues at the Resort Lobby Level

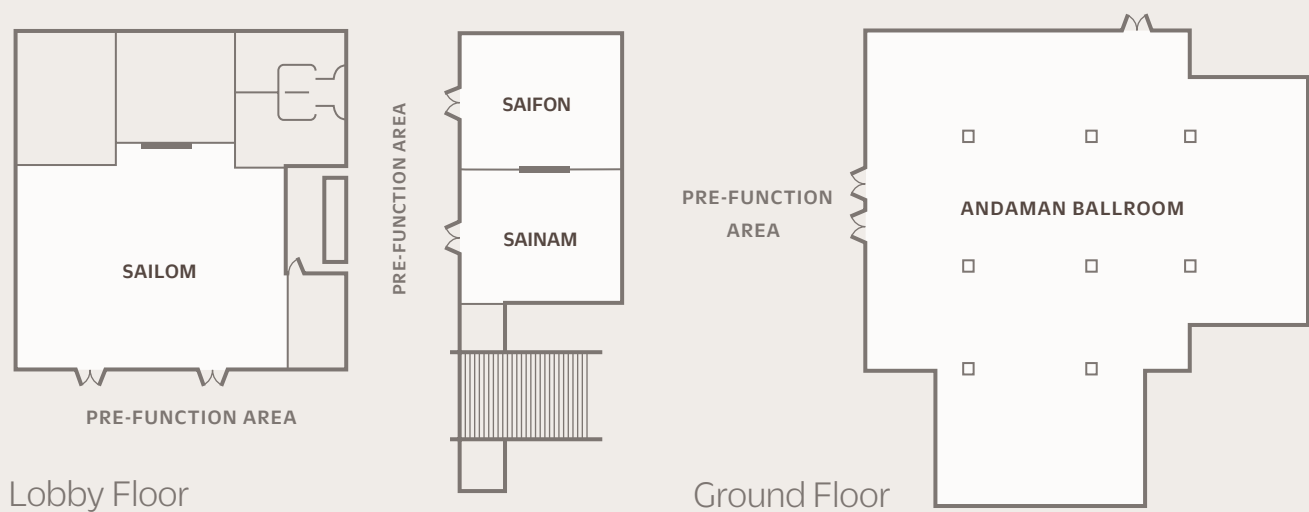

FULL-DAY DELEGATE PACKAGE INCLUSIONS

- Morning coffee breaks include freshly-brewed coffee, a selection of regular and herbal teas and an assortment of croissants, sandwiches, Danish pastries and muffins.
- Our executive chef and team ensure that lunch menus – from simple but satisfying to exciting local specialties – are a perfect fit for your event.
- Afternoon coffee breaks include freshly-brewed coffee, a selection of regular and herbal teas, and an assortment of snacks including fruits, curry prawn fritters, deep-fried sesame chicken wings, and smoked salmon and cream cheese bagels.
- Meeting rooms offer complimentary Wi-Fi, flip chart, LCD projector, built-in sound system, note pads, pens, drinking water and mints.
- Half-day packages are also available with a complimentary meeting room, one coffee break and lunch.
- A variety of events are possible at the resort or in the surrounding area. Our extensive gardens and beachfront areas create inspiring settings for outdoor banquets and team building activities.

ROOMS AND VOYAGER 47 CLUB LOUNGE

The resort features 164 Deluxe Rooms and 91 Club Rooms and Suites with exclusive access to the Voyager 47 Club Lounge and privileges - an ideal option for your VIPs.

GOURMET DELIGHTS

Locavore (international all-day dining restaurant), Edgewater Bistro and Bar (modern beachside dining and bar), Icon Terrace (all-day terrace bar with a stunning view of the swimming pool and Andaman Sea), Metzo's (Mediterranean inspired cuisine).

EVENT PARKING

Accessible car parking is available on site.

NEW MEETINGS AND EVENTS CENTRE

Total 6 function rooms with 672 square metres of conference, meeting rooms and 200 square metres of pre-function area spread over two floors and fully equipped with world class AV and WI-FI.

NEW SIMILAN BALLROOM

Six-metre high pillarless ballroom with the flexibility to be divided into three function rooms.

PRE-FUNCTION AREA

Spacious foyer with natural daylight ideal for themed coffee break and pre-dinner welcome drinks.

VIP LOUNGE

A dedicated VIP Lounge is fully equipped to ensure privacy and comfort for event VIP's, speakers and organisers.

2nd FLOOR MEETING ROOMS

The three breakout rooms, all with natural daylight, are perfect for holding small meetings, or for use as offices.







COMMUNITY SERVICE TEAM-BUILDING ACTIVITIES

Motivate your team and improve working relationships by helping the nearby Khok Wat Mai school, serving 100 pupils, mostly from underprivileged backgrounds.

SINGLE USE PLASTIC

We are working towards becoming a single-use plastic free resort. Our initiatives cover plastic bags, food containers, capped water bottles and utensils - essentially any item that is typically used one time and then thrown away. Real effort has been made to source reusable bottle containers and there is no single use plastic used in the bars and meeting venues.

Function Room Capacities

Room	Area (sqm)	Size (metres) Length x Width	Height (metres)	 Theatre	 Classroom	 U-Shape	 Cocktail	 Banquet	 Banquet + Dance Floor	 Boardroom
NEW MEETINGS AND EVENTS CENTRE										
Pre-Function Space	200									
Similan Ballroom	448	14 x 32	6.0	350	245	90	370	320	—	95
Similan A	112	14 x 8	6.0	100	60	35	100	70	—	35
Similan B	224	14 x 16	6.0	150	125	40	170	150	—	40
Similan C	112	14 x 8	6.0	100	60	35	100	70	—	35
2nd Floor										
Tongfah	112	14 x 8	3.0	90	45	35	100	60	—	30
Tawan	64	8 x 8	3.0	50	25	24	90	30	—	24
Talay	48	6 x 8	3.0	40	15	18	60	20	—	18
MEETING VENUES AT THE RESORT LOBBY LEVEL										
Sailom	158	15.30 x 10.30	2.8	100	54	45	120	80	40	48
Saifon	77	9.85 x 7.83	3.0	60	27	24	52	32	—	18
Sainam	77	9.85 x 7.83	3.0	60	27	24	52	32	—	18
Andaman Ballroom	716	30x 30	2.9 – 4.9	350	200	130	400	290	250	78

Laguna Phuket, 323 Moo 2
Srisoonthorn Road, Cherngtalay, Thalang
Bangtao Beach, Phuket 83110, Thailand
Phone: +66 76 360 600
Fax: +66 76 360 670
sm.phuketbeach@outrigger.co.th