

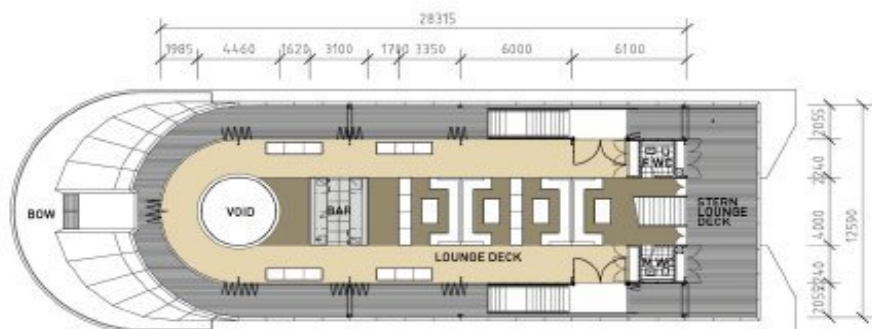

STARSHIP SYDNEY



1 LOUNGE DECK

Lounge Deck

Dedicated lounge area or Formal seated dining for 120 guests
 Concertina glass doors open on surround outside deck
 3 metre ceiling height
 Microphone, 2 plasma screens
 Bose audio system throughout
 3 phase and 240 volt power outlets
 Smoking area
 Glass viewing void to main deck area
 Male and female toilets
 Bar

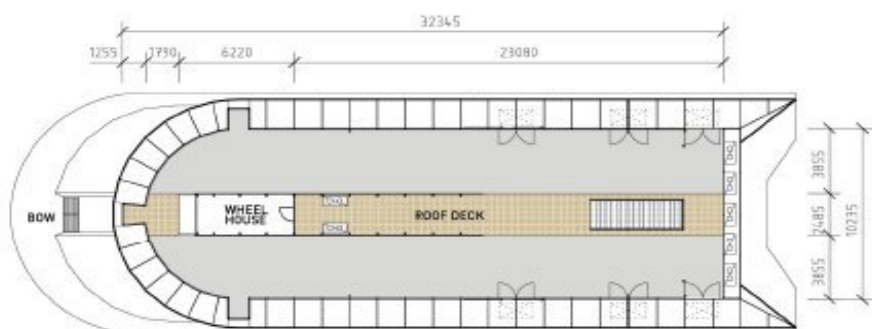

2 ROOF DECK

Top deck—Bridge Deck

240 volt power
 Cocktail tables
 Occasional seating
 Marquees and other structures permitted
 Subtle lighting
 Separate Sound system—Bose
 Microphone
 Smoking area



Below Deck

Main guest toilet facilities
 VIP / Green Room with plasma screen & mini bar
 Kitchen & storage
 Access to Car lift

1 BELOW DECK

Main Deck

Seating for 140—396 without dance floor
 Seating for 140—350 with dance floor
 Cocktail party 750 guests throughout vessel
 3 metre ceiling height
 Black butt feature/dance floor through centre
 Surround glass
 3 phase & 240 volt power
 6 plasma screens, USB inputs
 Bose sound system, microphone, DVD, I pod
 Dimensions approx 11m x 40m
 Bar

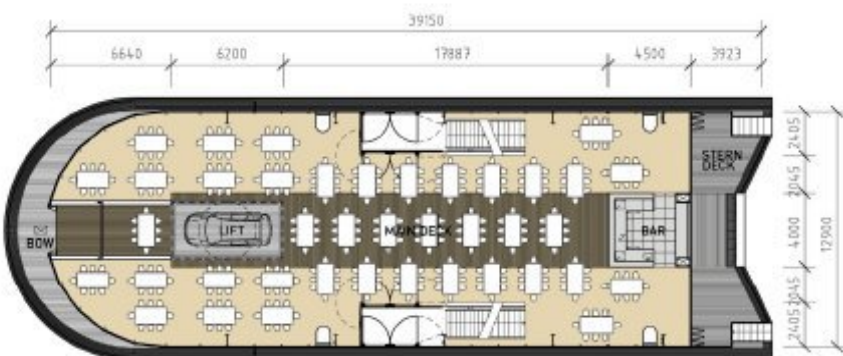

2 MAIN DECK